

# Product Installation Manual

## BA-1E

FOR:

BA129、BA130、BA131、  
BA132、BA134、BA135、  
BA136、BA137、BA138、  
BA139、BA141、BA142、  
BA351、BA351-1、  
BB127-1/-2、BB128-1/-2  
BH001E, BH002E, BH003E

# Product Installation Manual

## Installation Instruction for Counter Top Basin

### Before Installing

FOR:  
BA129、BA130、BA131、  
BA132、BA134、BA135、  
BA136、BA137、BA138、  
BA139、BA141、BA142、  
BA351、BA351-1、  
BB127-1/-2、BB128-1/-2  
BH001E、BH002E、BH003E

1. Realize all the stipulates for pipelines preposition for water supply and drain.
2. Make sure the wall has enough strength.
3. Read the instruction carefully to be familiar with the tools, fittings and installation procedures to prevent any unnecessary damage.
4. Check the fittings follow the fitting form and check whether there is any damage of the product.
5. Because the ceramics is easy to be damaged, please handle it gently and the nut should not be overtightened.
6. Make sure water supply has been turned off..

NOTE: 1. Refer to the newest information of the printed matter. We reserve the rights to change the features, packing and fittings of the products without notice.  
2. Please keep the installation instruction carefully (including installation procedure, fitting form, trouble shooting and notice.)

### Tools and Fittings (Not supplied with the product)

- |                 |                      |
|-----------------|----------------------|
| 1.monkey wrench | 5.level              |
| 2.pipe wrench   | 6.silicone           |
| 3.tapeline      | 7.water supply valve |
| 4.cutter        |                      |

# Installation Procedure

1. Choose the size and the height of installing table according to the specification of the product.

Note: 1). Installing height means the height from the floor to the top surface of front edge of the basin.

2). Installing height suggestion: between 800-840mm.

2. Mark the centre line on the installing table, then put the basin onto the table against wall. Move the basin to the position of centre line, then mark the contour line along the interface of basin and table.

Note: Check there is enough distance between faucet and wall before you mark line to make sure you can turn on/off the faucet well.

3. Remove the counter top basin, then mark the cutting line for installing drain units along the marked contour line.

4. Drill one hole inside the marked cutting line a little distance from the line, and cut out the installing hole along the cutting line.

5. Install the faucet and the drain units according to the installation instruction from the manufacturer.

6. Put the counter top basin into the installing hole on the table, and make sure the bottom of basin aligned with the contour line.

7. Get the supply pipe and the drainage pipe connected according to the installation instruction for faucet.

8. Daub a layer of silicone on the interface of basin and table for fixing.

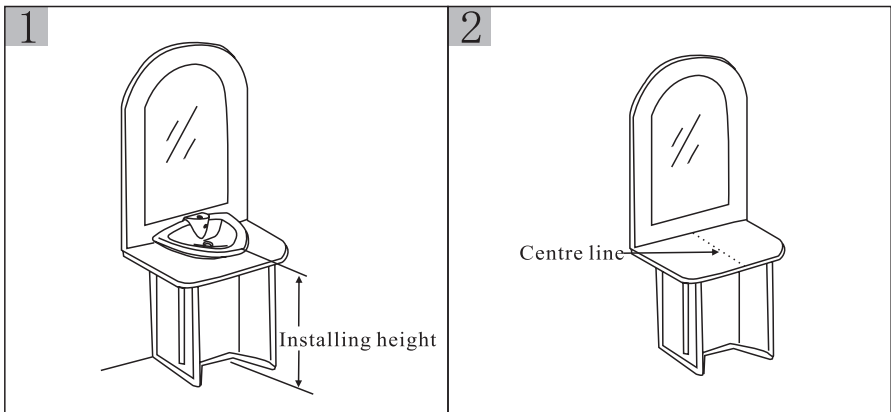

3

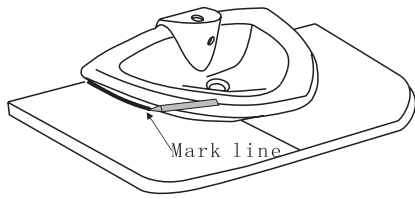

4

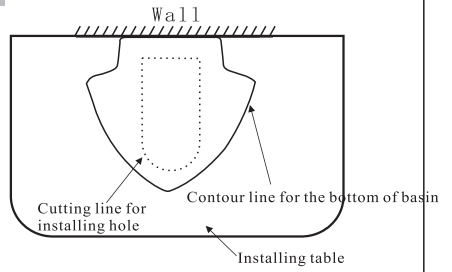

5

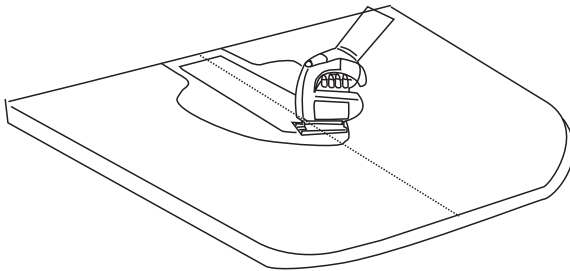

6

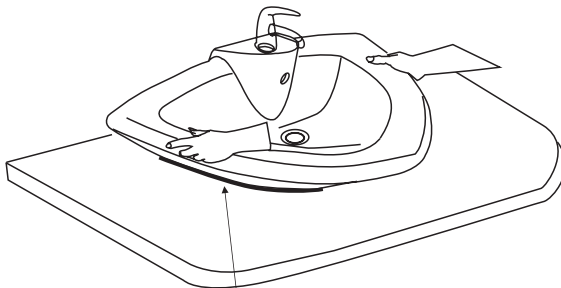

The bottom of basin should be aligned with the contour line

7

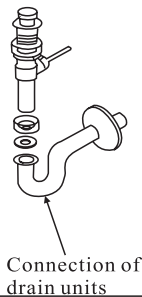
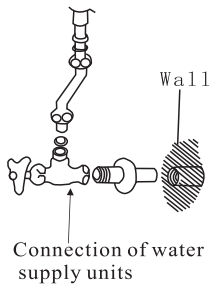

8

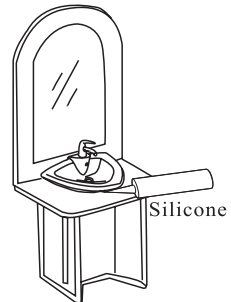

# Troubleshooting

Malfunctions	Causes	Solutions
No water remained in the basin	1. Waste and water outlet have not been sealed. 2. gasket of adjusting valve for waste is broken.	1. Readjust and get them sealed. 2. Change the gasket.
Slow drainage	1. The angle of connecting bar is not enough 2. Water outlet has been plugged.	1. Readjust the angle 2. Clean the water outlet
The basin is overflow or smell	The drainage pipe has been plugged.	Check and clean the pipe

## NOTE:

1. Do not use the basin when the water temperature is 0°C below, please stop using it when the temperature is under 0 degree centigrade, and clean away the surplus water in it, otherwise the product will be damaged when the water icing and expanded.

2. Please keep the product cleaning if it is used in hard water area.  
Cleaning suggestion: once a week.

3. Do not use corrosive chemicals to clean the product to prevent any damage of glaze.